

# Reverse Hyper Rig Attachment

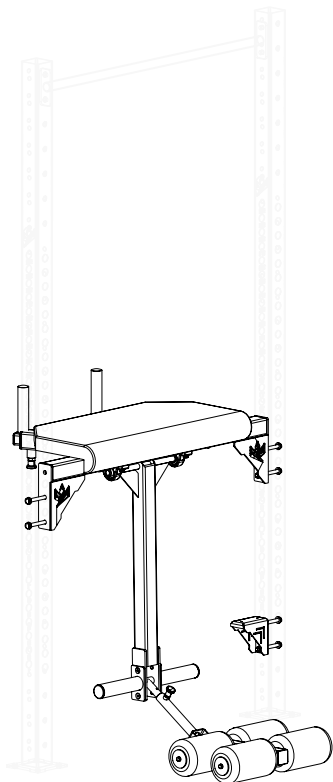

**KingsBox®**  
BUILDING BETTER HUMANS

## **ATTENZIONE!**

**Se la struttura non viene fissata a terra e/o al muro, può rib-altarsi e/o provocare danni a persone o oggetti in immediata vicinanza.**

I bulloni per il fissaggio del rig a muro e/o al pavimento non sono inclusi nel pacco, in quanto per diversi tipi di muro e pavimentazione bisogna utilizzare diversi tipi di bulloni d'ancoraggio.

---

## **OPOZORILO!**

**Če se struktura prevrne, lahko pride do resnih telesnih poškodb. Da bi preprečili nevarnost, da se ta struktura prevrne, mora biti pritrjena na steno in / ali v tla.**

Vijaki za pritrjevanje strukture na steno oz. tla niso priloženi, saj različne sestave zidov oz. tal zahtevajo različne vrste pritrdilnih elementov. Uporabite take, ki ustrezajo sestavi vaše stene oz. tal.

---

## **WARNING!**

**If the structure is not secured to the ground and / or to the wall, it may overturn and / or cause damage to person or object in the immediate vicinity.**

The fixing bolts for wall and / or floor are not included in the pack-age, since different types of anchor bolts must be used for different wall / floor types.

# Assembly elements:

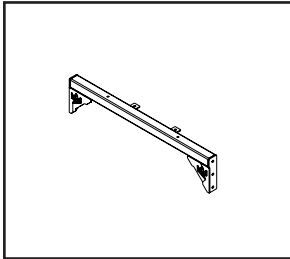

**Position 1**

**RH Profile Rig Attachment**

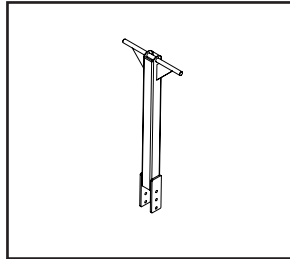

**Position 2**

**RH Pendulum**

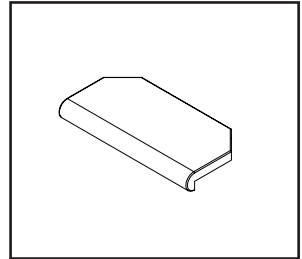

**Position 3**

**RH Pillow**

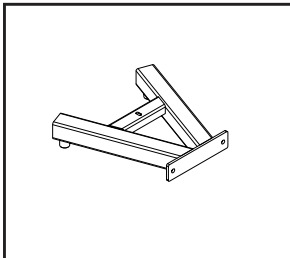

**Position 4**

**RH V Arm**

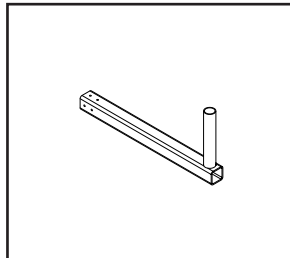

**Position 5**

**RH Adjustable Arm**

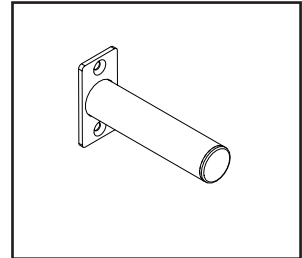

**Position 6**

**RH Bumper Stacker**

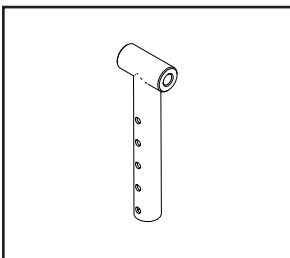

**Position 7**

**RH Extension #2**

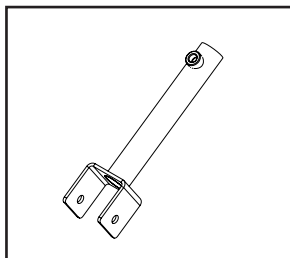

**Position 8**

**RH Extension #1**

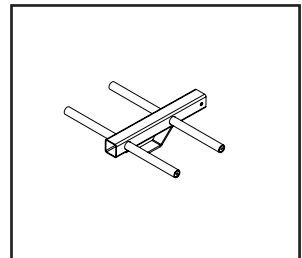

**Position 9**

**RH Pillow Holder**

# Assembly elements:



**Position 10**

**GHD Pillow Ring**

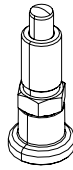

**Position 11**

**Index Plunger fi12  
M20**

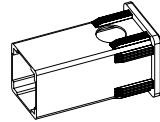

**Position 12**

**Vodilo Profila 60-40**



**Position 13**

**Rubber Handle RH**



**Position 14**

**Čep 40x40**

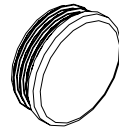

**Position 15**

**RH Pillow**



**Position 16**

**Index Plunger  
M12x1,5**



**Position 17**

**Vodilo Profila fi28-  
25**

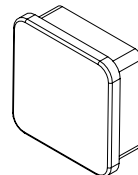

**Position 18**

**Čep 50x50**

# Assembly elements:

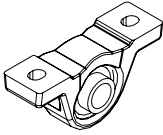

**Position 19**

**UCP 204**

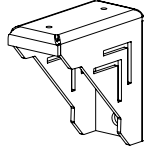

**Position 20**

**RH Step**

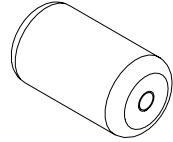

**Position 21**

**GHD Pillow**

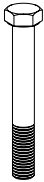

**Position 22**

**M12x90**

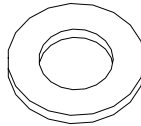

**Position 23**

**M12 Washer**

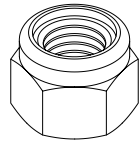

**Position 24**

**M12 Nuts**

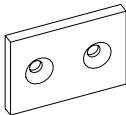

**Position 25**

**J-cup S Plastic II.**

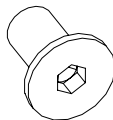

**Position 26**

**M5x10 Countersunk**

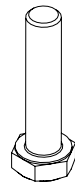

**Position 27**

**M10x40**

# Assembly elements:

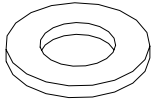

**Position 28**

**M10 Nuts**

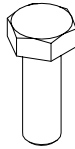

**Position 29**

**M10x40**

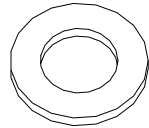

**Position 30**

**M8 Washer**

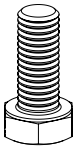

**Position 31**

**M8x20**



**Position 32**

**M8x90**

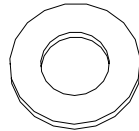

**Position 33**

**M10 Washer**

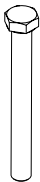

**Position 34**

**M12x100**

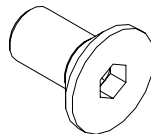

**Position 35**

**M10x30 Counter-  
sunk**

# Assembly instruction:

## STEP: 1

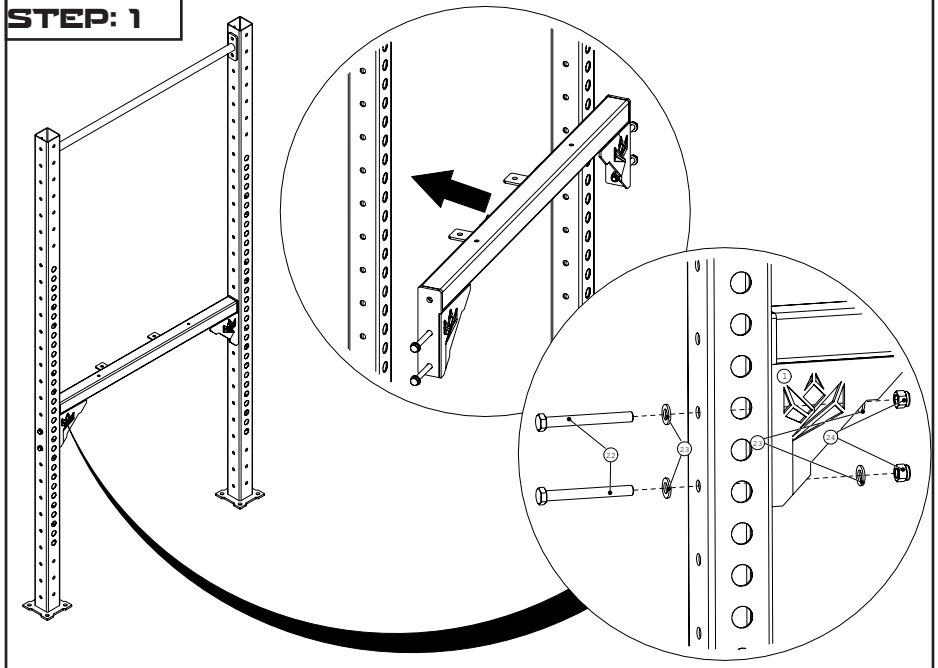

## STEP: 2

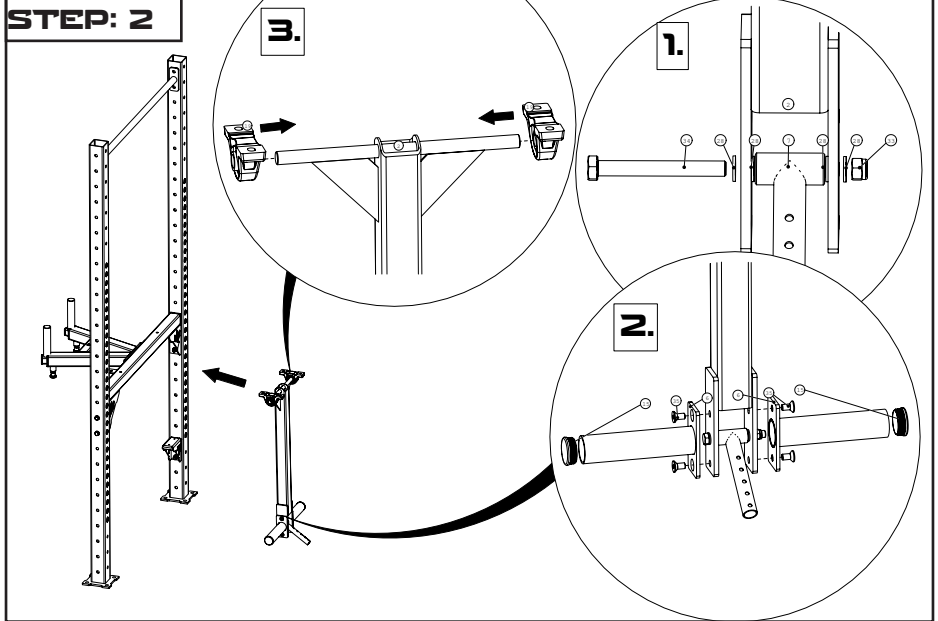

# Assembly instruction:

## STEP: 3

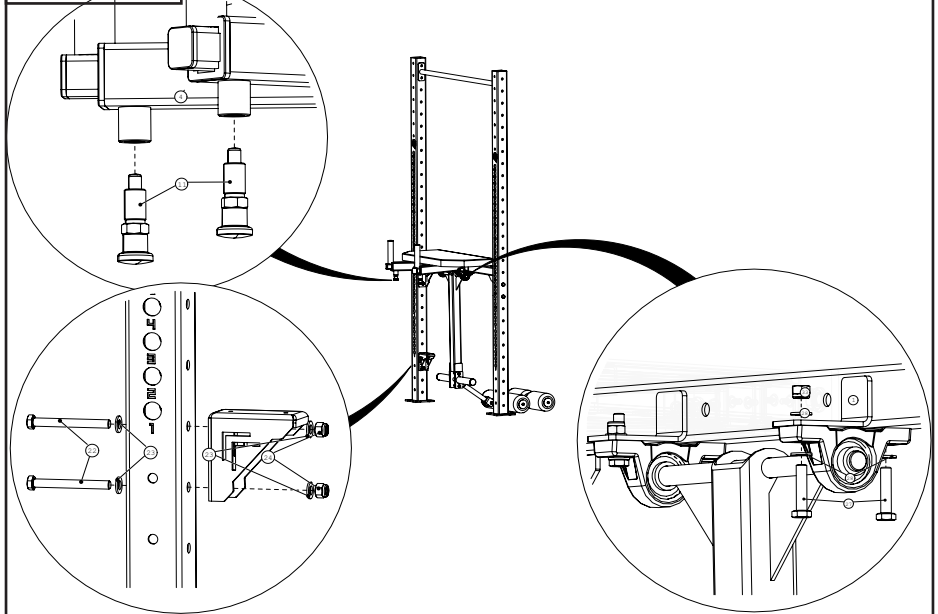

## STEP: 4

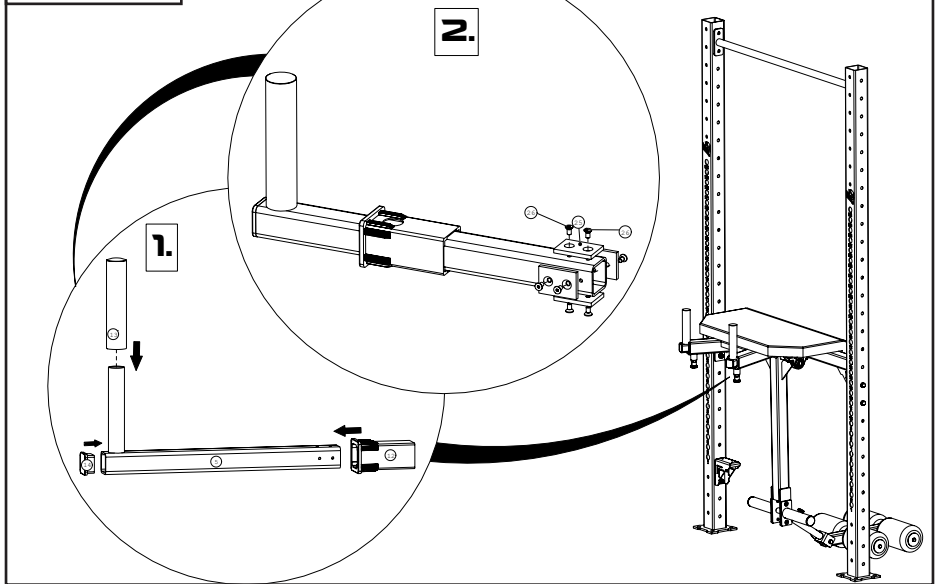



# Assembly instruction:

## STEP: 5

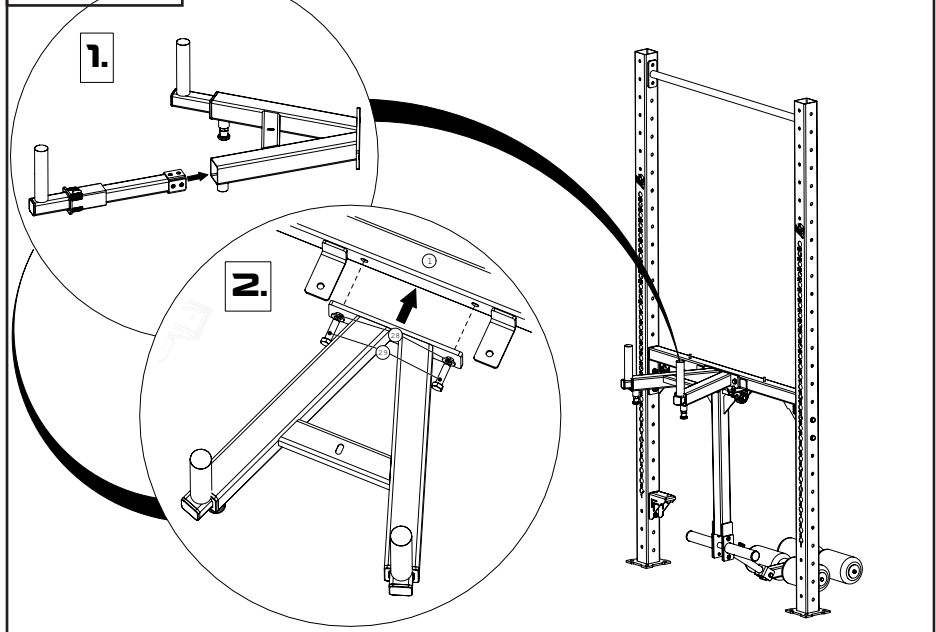

## STEP: 6

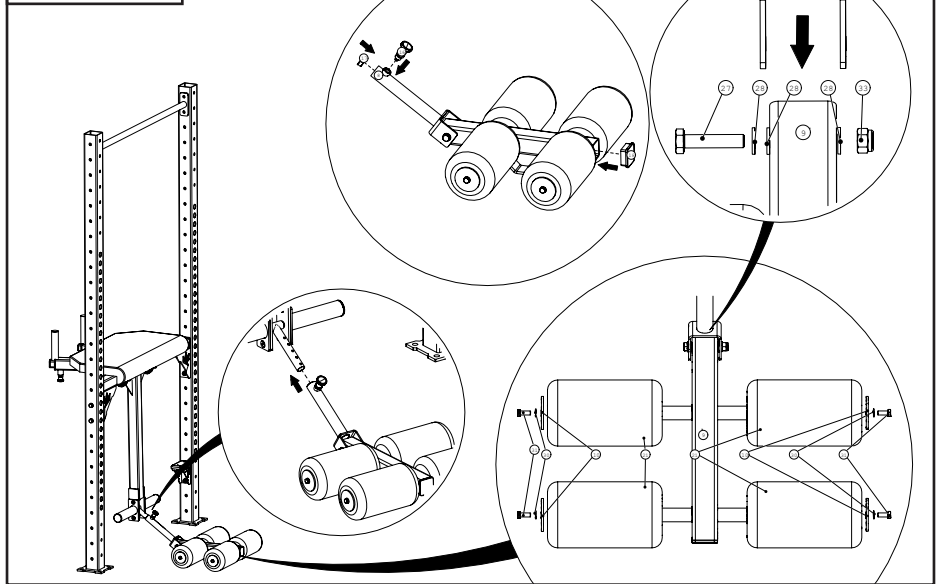

# Assembly instruction:

**STEP: 7**

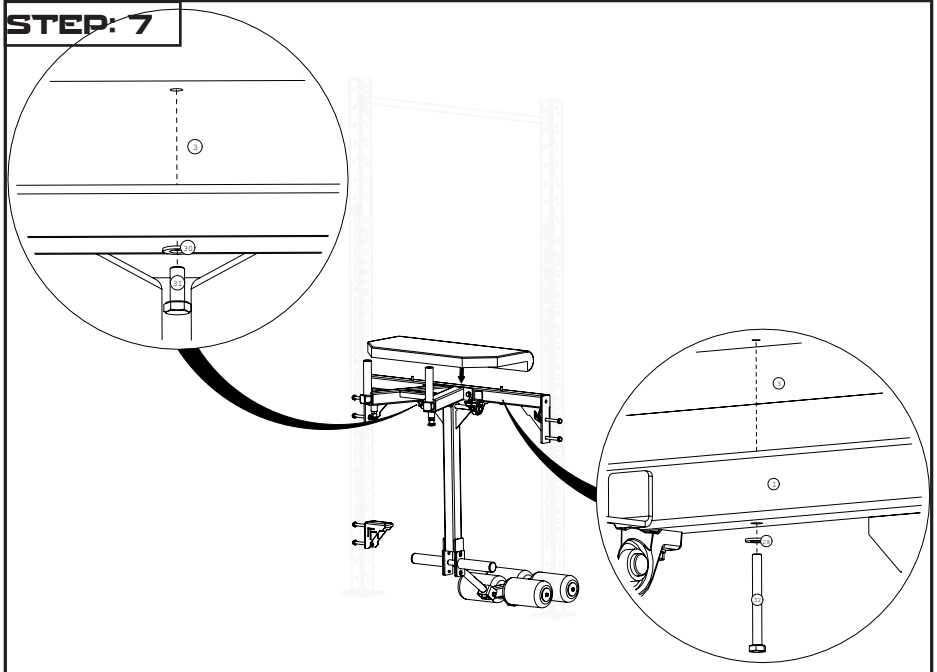

**STEP: 8**

