

# Round Dumbbell Rack

(KB08MI-017)

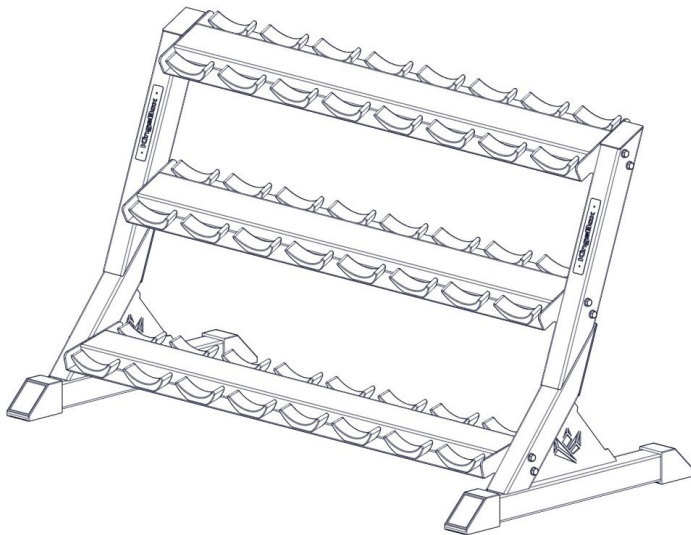

**Manufacturer:**  
Kingsbox d.o.o.  
Bazoviška 7a, 6210 Sežana  
Slovenia



**Customer service:**

Write us on [info@kingsbox.com](mailto:info@kingsbox.com) or send us a message through our website at [www.kingsbox.com/help](http://www.kingsbox.com/help)

**Usage class:**

Indoor use - Studio (S)

**Designed in compliance with:**

ISO 20957

Gym owner shall provide the user with all the warnings and instructions. The training equipment shall only be used in areas where access, supervision and control is specifically regulated by the owner.

For training equipment designed with stacked weights - person exercising should face the training equipment at all times during the exercise to prevent danger to a third party.

**Warnings:**

- Freestanding equipment shall be installed on a stable and levelled base
- All equipment designed with anchoring/attachement holes (e.g. rigs, racks, equipment and accessories for racks, storage pins/shelves, etc.) should be securely screwed to the fixed ground/wall/structure through all the designated fixing holes and with appropriate sized screws.
- Injuries to health may result from incorrect or excessive training
- Keep unsupervised children away from the equipment

**Maximum mass on storage shelves:** 240 kg/shelve (applies to both 3 shelves version and extended (6 shelves) version).

<sup>(1)</sup> Training mass - achieved through different means of resistance (weight plates, stacked weights, dumbbells, elastic cords, etc.), excluding user's

## Assembly elements:

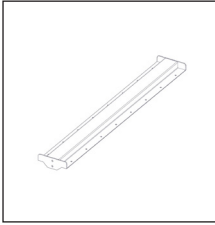

**Position 1**  
Round Dumbbell Shelf (3x)

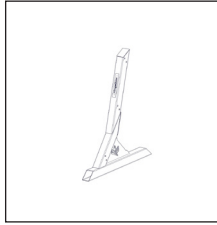

**Position 2**  
Dumbbell Rack Leg (2x)

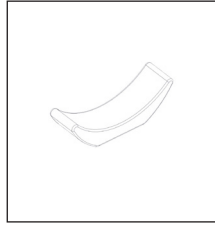

**Position 3**  
Round Dumbbell Holder (48x)

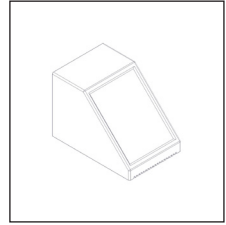

**Position 4**  
Rubber Leg 80x80 (4x)

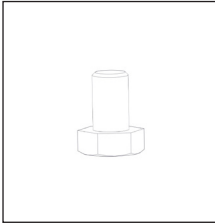

**Position 5**  
M10x16 (48x)

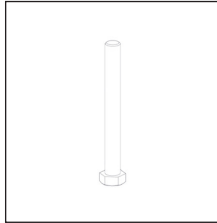

**Position 6**  
M12x120 (12x)

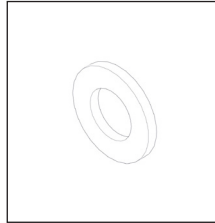

**Position 7**  
Washer M10 (48x)

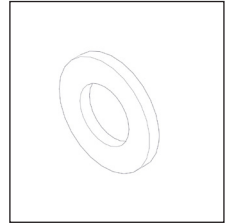

**Position 8**  
Washer M12 (24x)

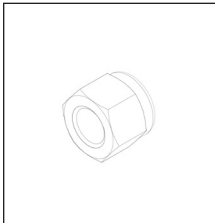

**Position 9**  
Nut M12 (12x)

## Tools needed:

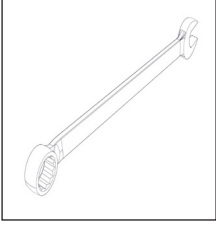

**Wrench 19**  
2x

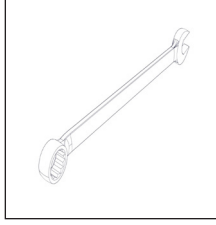

**Wrench 17**  
2x

# Assembly instruction:

# 1

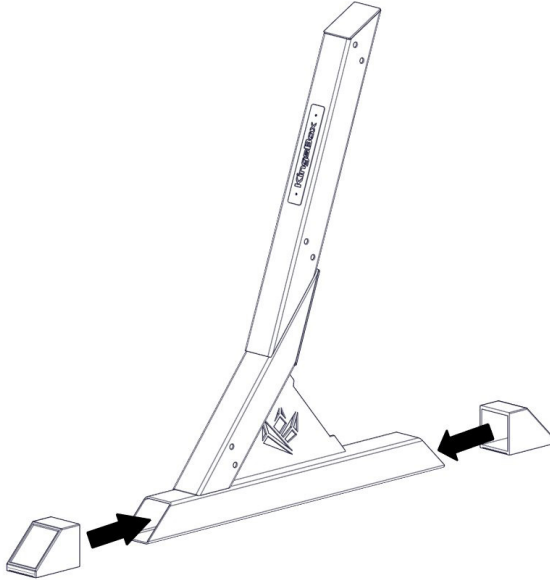

# 2

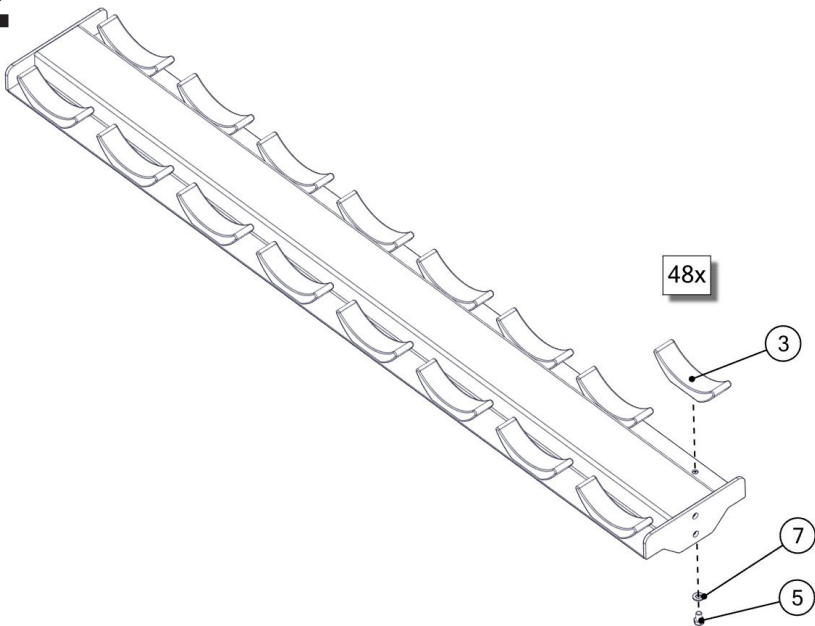

# 3

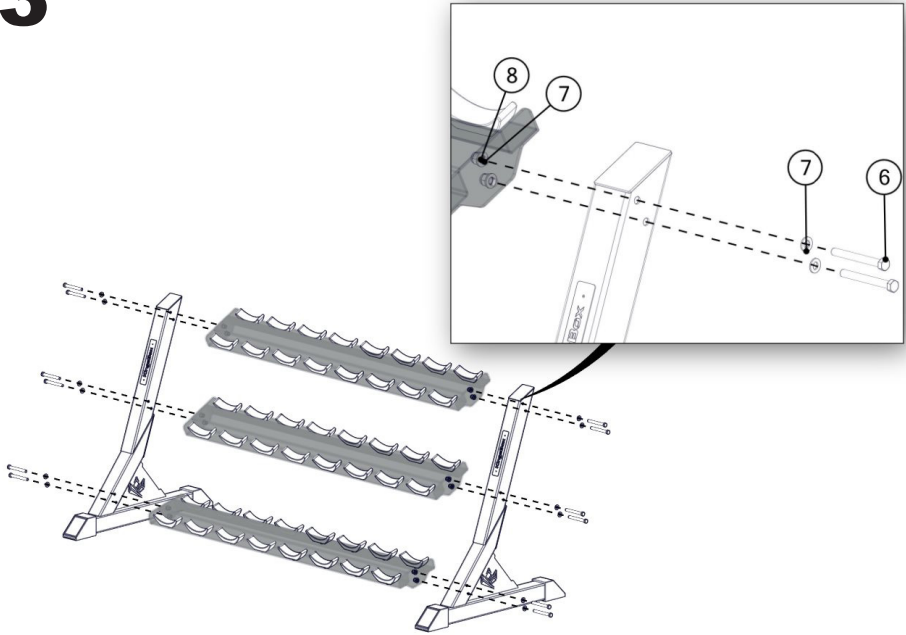

# 4 - the end

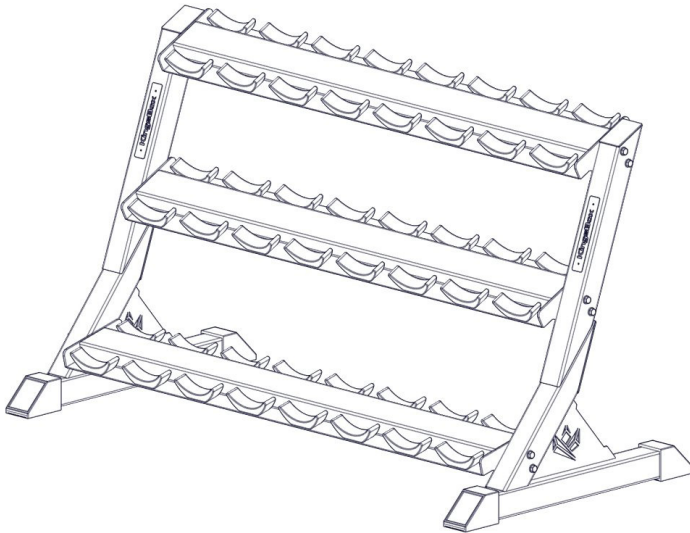

# Instructions for use:

Max. loading:

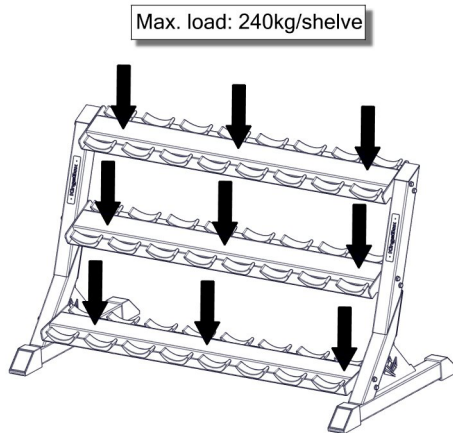

Note: Suitable for round dumbbells with max. body diameter fi200.